



PRODUCT PORTFOLIO



scil Rapid Tests for Dogs & Cats

scil v-Corona

test for detection of Coronavirus antigen (CCV / FCoV) in dogs and cats

scil v-Giardia

test for detection of Giardia duodenalis antigen in dogs and cats

scil v-ParCo

test for detection of Parvovirus- and Coronavirus antigen in dogs and cats

scil v-ParCoGia

test for detection of Parvovirus-, Coronavirus- and Giardia duodenalis antigen in dogs and cats

scil v-Parvo

test for detection of specific Parvovirus antigens in dogs and cats



scil Rapid Tests for Dogs

scil v-Diro

test for detection of Dirofilaria immitis infection in dogs

scil v-Ehrlichia

test for detection of Ehrlichia canis antibodies in dogs

scil v-Leishmania

test for detection of Leishmania antibodies in dogs



scil Rapid Tests for Cats

scil v-RetroFel

unique test for simultaneous detection of FeLV antigen, FeLV antibodies and FIV antibodies in cats

scil v-FeLV

test for detection of FeLV antigens in cats

scil v-FeLV-FIV

test for detection of FeLV antigen and FIV antibodies in cats

scil v-FIV

test for detection of FIV antibodies in cats



www.scilvet.com

Vers. ENG20180511



scil v-Diro

fast - accurate - clear

Test for detection of Dirofilaria immitis infection in dogs



TEST INFORMATION

Canine heartworm disease is a chronic disease due to infection with *Dirofilaria immitis* larvae and worms. 6-7 month after infection adult female and male worms become apparent and can specifically be detected using the scil v-Diro assay. The clinical picture of the disease varies in affected dogs. Mild cases may be asymptomatic but more severely affected patients can show different

stages of respiratory and cardiovascular diseases. The parasite is endemic in many tropical and subtropical regions. Therefore regular prophylactic treatment is needed for the dogs as well as checks for infectious status using the scil v-Diro assay.

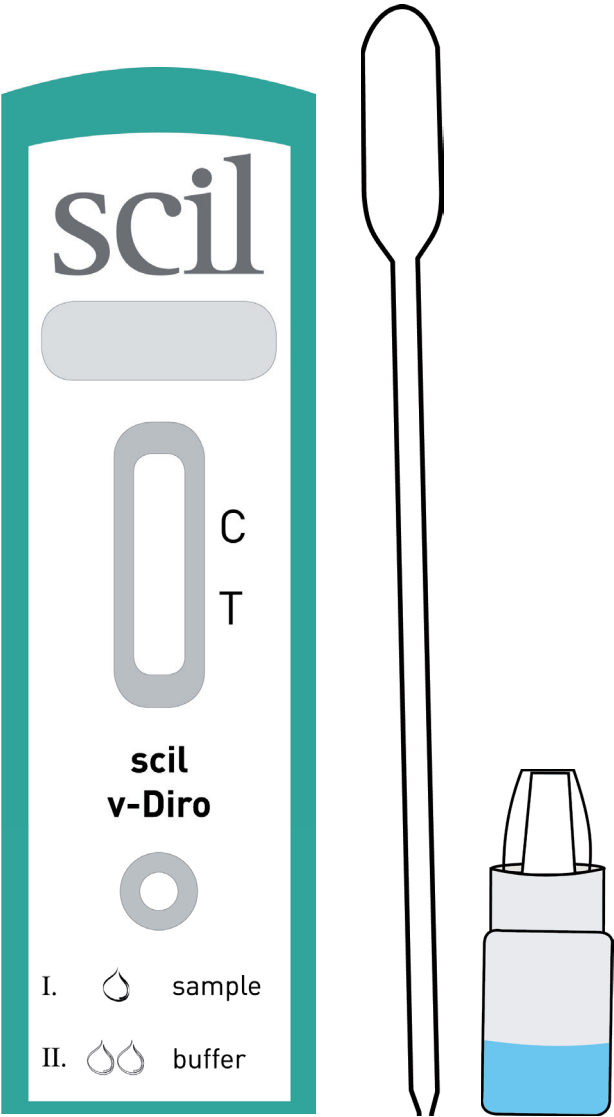

TEST COMPONENTS

- >> scil v-Diro test cassette
- >> pipette
- >> reagent bottle

TEST PERFORMANCE

	Sensitivity	Specificity	Reference	n
Dirofilaria	96.67 %**	99.99 %	ELISA*	84

* Enzyme-linked Immunosorbent Assay
** compared to Knott test

TEST PROCEDURE

Step 1:

Take up the sample with the pipette and put carefully one drop (30 µl) of sample material into the sample well.

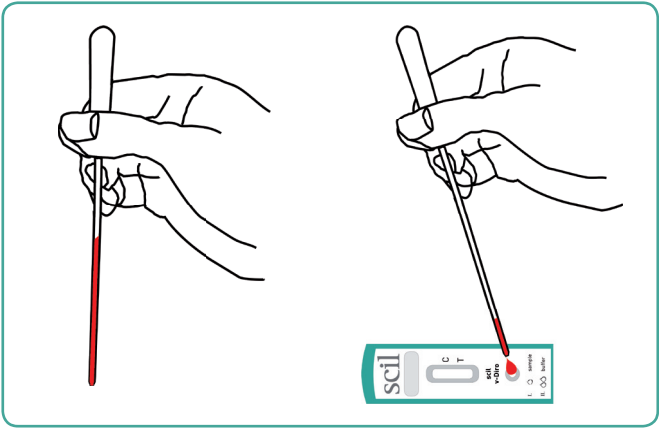

Step 2:

Add two drops of the reagent from the reagent bottle into each sample well.

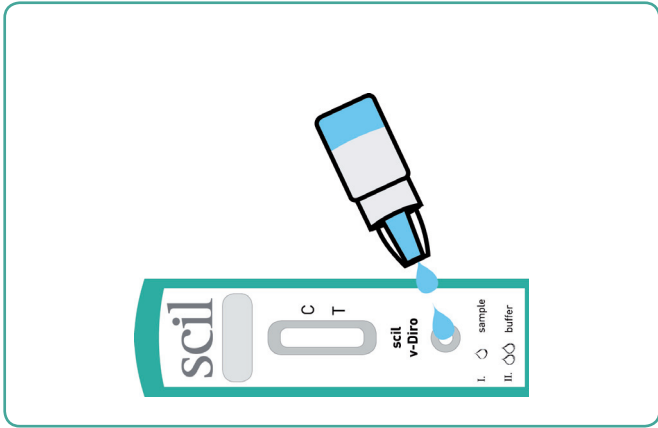

TEST EVALUATION

The result of the test can be read after 10 minutes.

A red line in the T-region (T) of the reaction field indicates a positive test result.

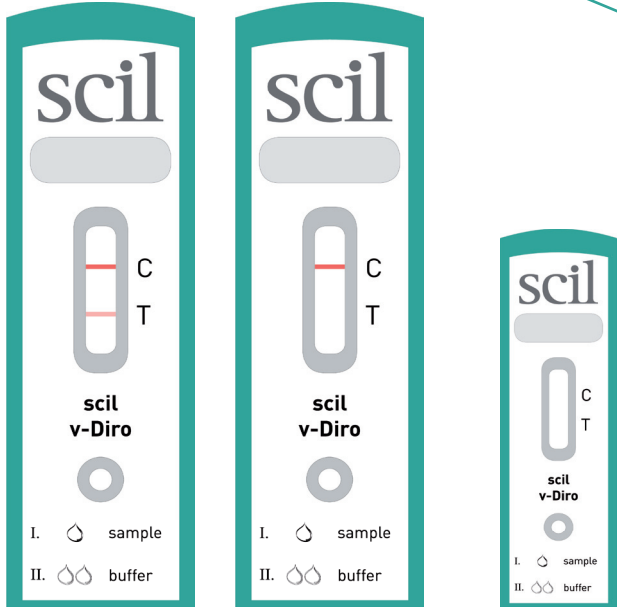
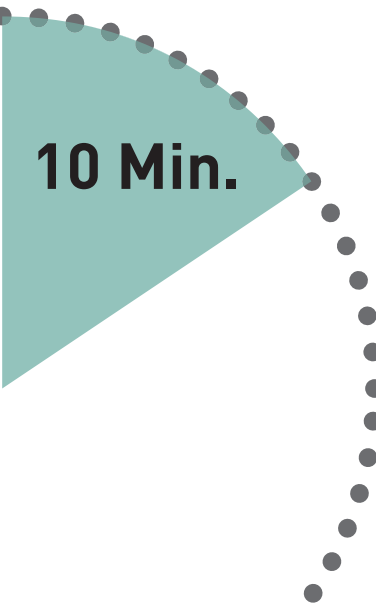

positive negative invalid